

Technical data sheet

**Modell TST56
for inward/outward opening doors**

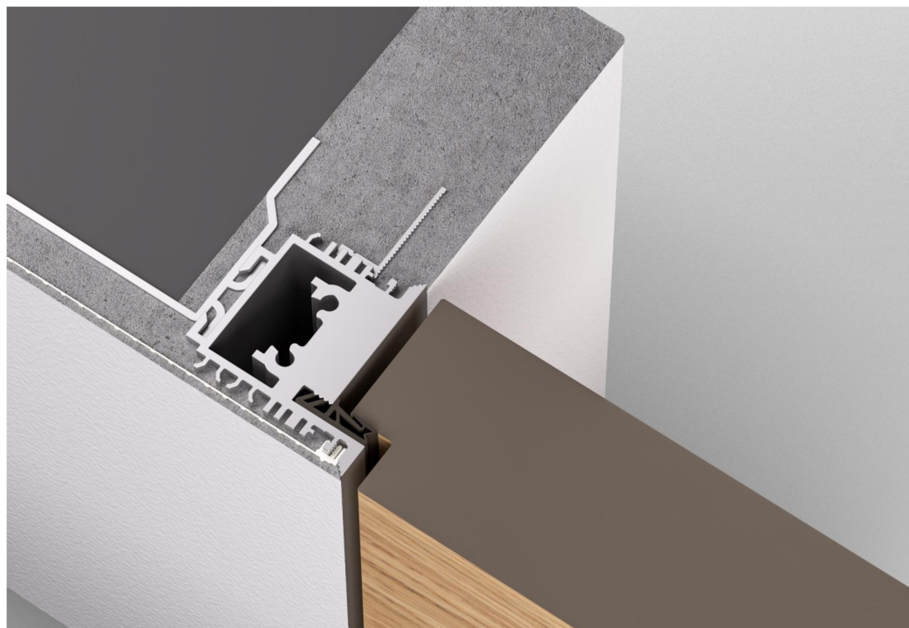

Index

Profile detail.....	2
Recommendations	2
Suitable hinges.....	3
Suitable striking plates.....	3
Suitable door closers.....	4
Suitable seals.....	4
Door leaf	5/6
Inward opening doors	5
Outward opening doors	6

Profile detail

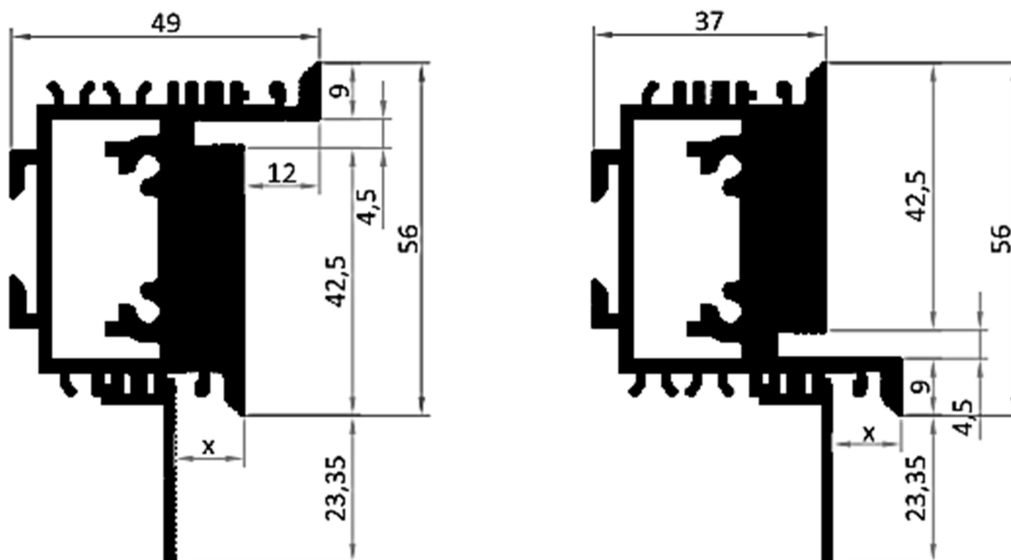

X = 11/14 mm

Modell TST56

Suitable for solid and dry construction

The frame profiles are supplied mitre-cut to suit door size, and machined to suit concealed hinges, lock strikes and other hardware. In combination with the snapIn corner connectors and the mounting brackets, this enables quick assembly and professional installation. The snap-in mesh ensures no plaster cracks between wall and frame. Suits standard or floor-to-ceiling doors.

Here you can find the assembling video:



masonry construction



drywall

Recommendations

On the basis of detailed tests and long-term experiences our technical office has prepared a recommendation-list regarding the selection of hinges, closing panels and seals. These lists are practical guidelines and non-exhaustive.

RECOMMENDATION		
Suitable hinges		
Producer	Designation	Weight
Anselmi www.anselmisrl.it	AN 161 3D FVZ 12	40kg
	AN 164 3D FVZ 12	60kg
	AN 172 3D	60kg
Krona Koblenz www.kronakoblenz.com	KUBICA HYBRID K2760	60kg
	KUBICA HYBRID K2780	80kg
Otlav www.otlav.it	INVISACTA IN570	60kg
Simonswerk www.simonswerk.it	TECTUS TE311 3D FVZ	60kg

RECOMMENDATION	
Suitable striking plates	
Producer	Designation
AGB www.agb.it	EASY-MATIC XT B01402.11.XX
	MINIMAL XT B02402.05.XX
	ALUTOP XT B0204.09.XX
	MINIMAL PLUS XT B02402.28.XX
Basys www.basys.biz	Basys SBL 2-L adjustable V3 li/re, magnetic
	Basys SBL Nr. 64 adjustable V3 li/re
	Basys SBL Nr. 106 adjustable V3 magnetic
Bonaiti Serrature SpA www.bonaiti.it	G992
	G994
	G995
	GI98
	GIS8
	GR95
	GR96

	GR97
	GS91
Dormakaba www.dormakaba.com	SB/MAG/120.20.2,0
	SB/MAG/210.20.2,0
	SB12/MAG/VAR/DS
KFV www.kfv.de	FSS 116-120-20HR
	FSS 116-200-20HR
	FSS 116-245-18HR
	FSS 116-245-20HR

RECOMMENDATION Suitable door closers	
Producer	Designation
Athmer www.athmer.com	PORTI 5371
Dormakaba www.dormakaba.com	ITS 96 EN 2-4 + G 96 N20 K8
Geze www.geze.com	Boxer EN 2-4 + 12 mm Slide rail

RECOMMENDATION Suitable seals/gaskets	
Producer	Designation
Deventer Profile GmbH www.deventer-profile.com	DS 6922a
Helmut Goll GmbH www.helmutgoll.com	A1020
Primo Profile GmbH www.primo.com	ACF 5602 H
SchlegelGiesse – Giesse S.p.A www.schlegelgiesse.com	QL 3096
	QL 3104

Door leaf

Inward opening doors

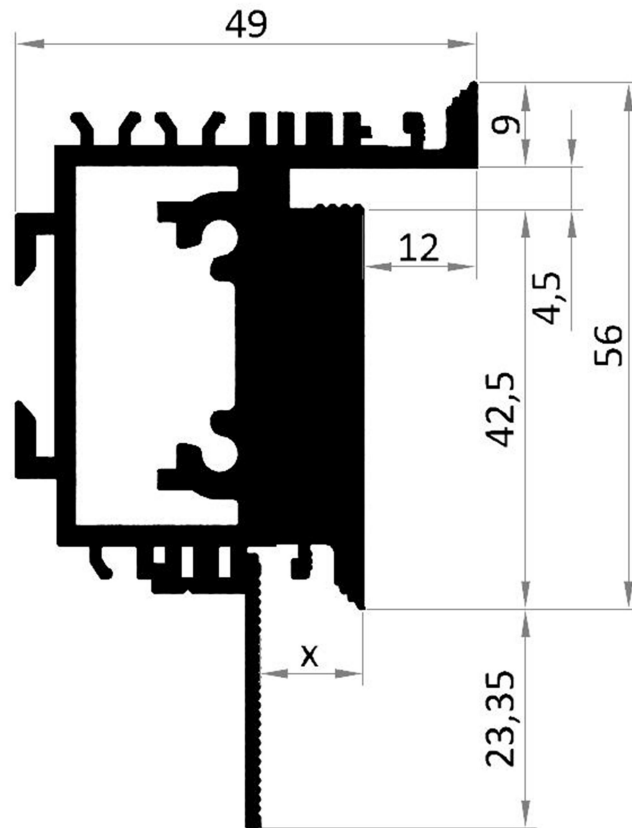

Rebate dimension for 5mm door seal

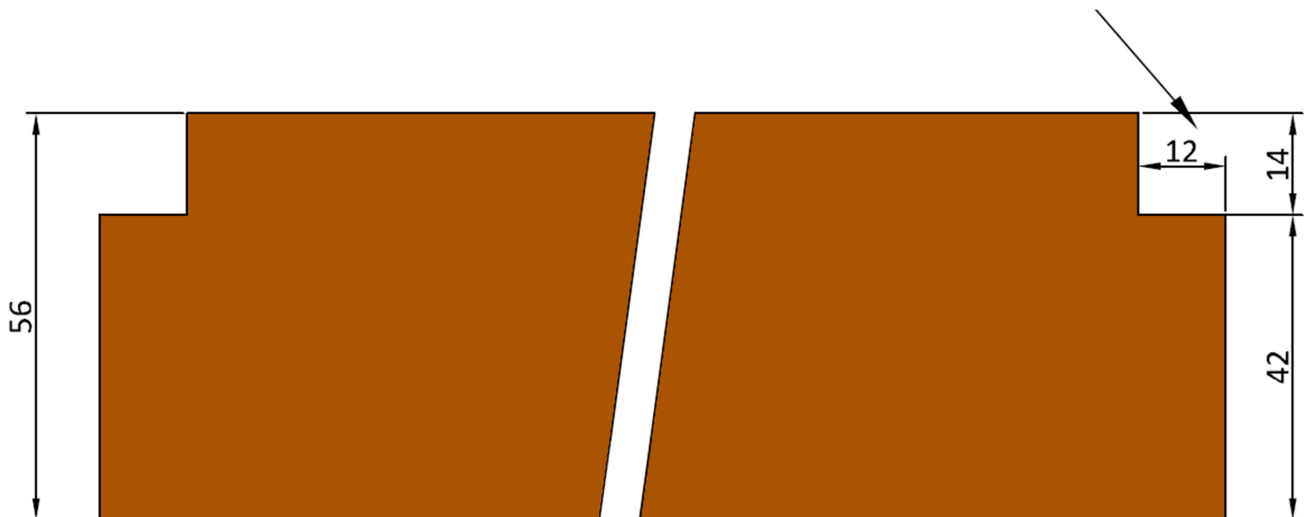

Outward opening doors

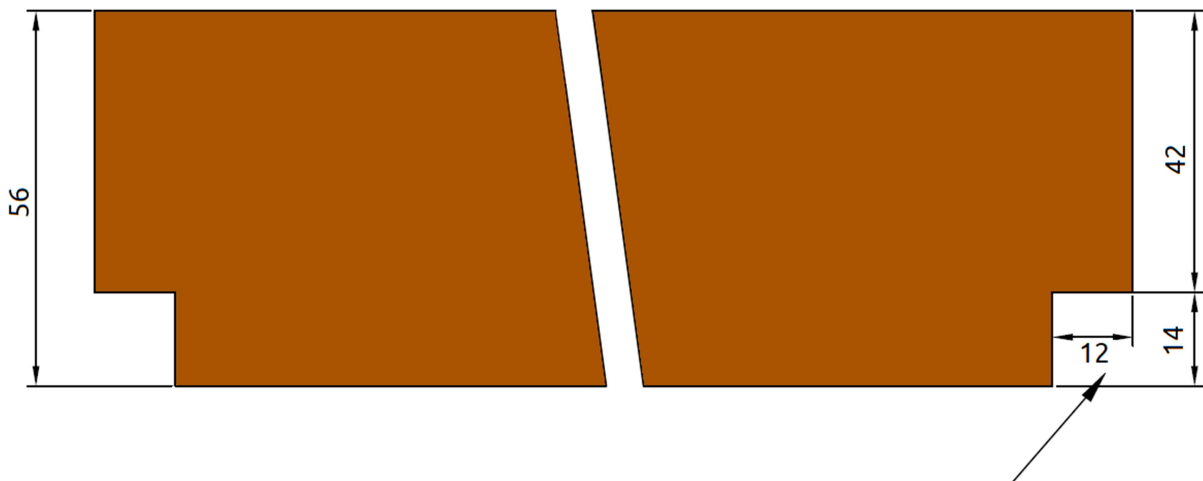
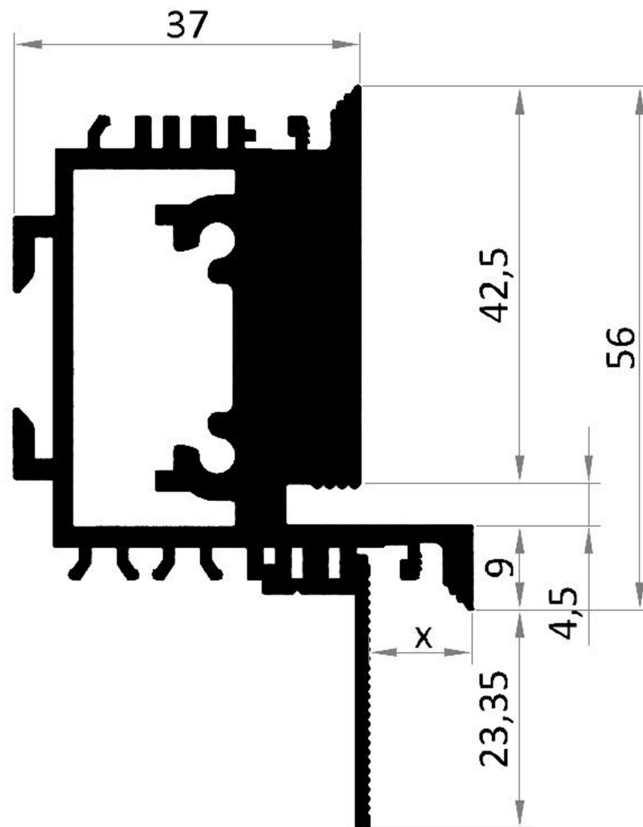

Rebate dimension for 5mm door seal

We guarantee for a high quality of our products. Our processing guidelines are based on tests and practical experiences; they are only indication without assurance of properties, we have no influence on condition of construction sites and the realizations of the works, Country specific regulations, which consist on regional standards, building regulations, processing and industrial guidelines, can guide to specific processing recommendations.