

Concealed door frames
TL
for inward/outward opening doors

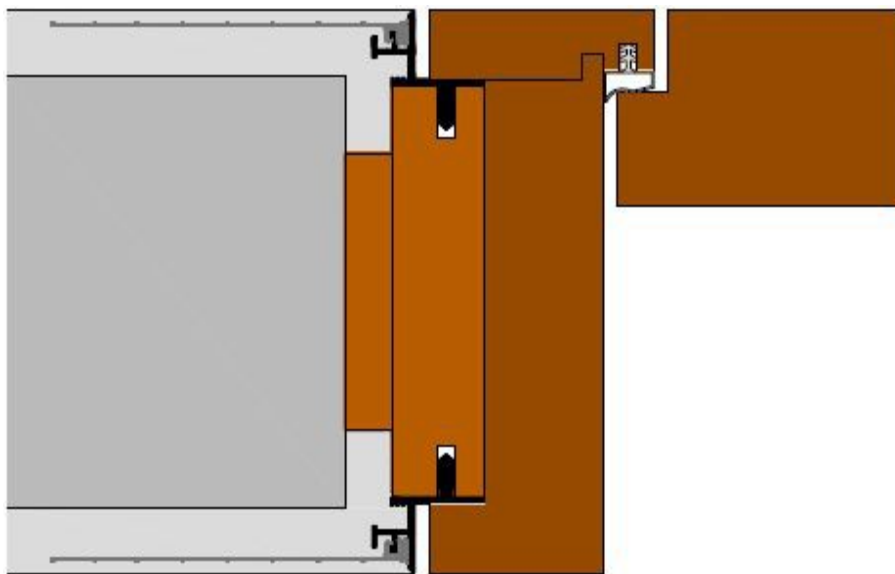

Description



The aluminium profiles TL are used to create a wall flush **TIMBER DOOR** frame. Planned for maximal **flexibility** they guarantee perfect finished edges, exact lines and filigree shadow gaps. With the clear lines and the smooth junction between the door leave, the timber door frame and the wall they refine the visual effects of the room and accomplish all demands of modern architecture. Thanks to the special structure and the snap-in mesh they offer a permanent connection between door elements and the wall. They eliminate plaster cracks and avoid an inconvenient acrylic gap. The offered functionality with the fast and professional assembly through the push fitted onto grooves profile outstrips the concept of design.

Material



The door profiles are made of raw untreated aluminium alloy EN EW-6060 (Al-MgSi) with a possible toleration according to UNI EN 755-9. This alloy offers good stability values and it especially suits as a construction material for high surface requirements. The profiles are covered by a protective film and are delivered pre-drilled with a length of 2 metres.

Cement and his derivatives produce alkaline substances when getting wet, which can provoke corrosion if they have time to work on the surface of the aluminium alloy. We reccomend to keep the profiles clear from cement, glue and joints material.

Aluminium is not resistant against all chemical compounds, so the contact with hydrocarbon (HCl) and phosphoric acid (H₃PO₄) should be avoided. Also cleaning products for stones, ceramics and suchlike can damage the surface.

Assembly



The assembly must be done in the bare brickwork. The push-fitted onto grooves system guarantee a fast assembly. The assembly must be done with caution and by using gloves. After plastering services the door panels must be installed. The manual guide must be read carefully before beginning with the assembly of the frame. For a professional installation only the materials from AGS must be used, otherwise every liability expires.

Door leaf



The door leave can have a thickness from 40 to 60mmm and from standard to ceiling high.

Profile

The TL profiles are available as standard lengths of 1100mm, 2200mm and 2750mm on stock ready to be shipped in a short time. All profiles are covered by a protective film.

TL

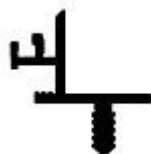

| TL | |
|-----------------------------------|--------------------|
| <u>Solid and dry construction</u> | |
| <i>Description</i> | <i>Item number</i> |
| TL | 10110 |

We guarantee for a high quality of our products. Our processing guidelines are based on tests and practical experience; they are only indication without assurance of properties, we have no influence on condition of construction sites and the realizations of the works

Country specific regulations, which consist on regional standards, building regulations, processing and industrial guidelines, can guide to specific processing recommendations.