

Concealed profiles for shadow gaps

S22 for solid and dry construction**Description**

The S22 aluminium profile for dry construction is used to create **wall flush shadow gaps**. The furniture can be placed against the wall without the need of reworking the dado. With its clear lines and a fluent passage from the skirting board to the plaster they refine the **visual effect** of the room and meet modern design standards. Because there is no direct contact between floor, skirting board and brickwork the flush is the ideal impact footfall sound solution. The profiles are useable in many different ways and can be also installed on stairs and curved walls. The flush guarantees timeless elegance, peace and familiarity inside your own four walls.

Material

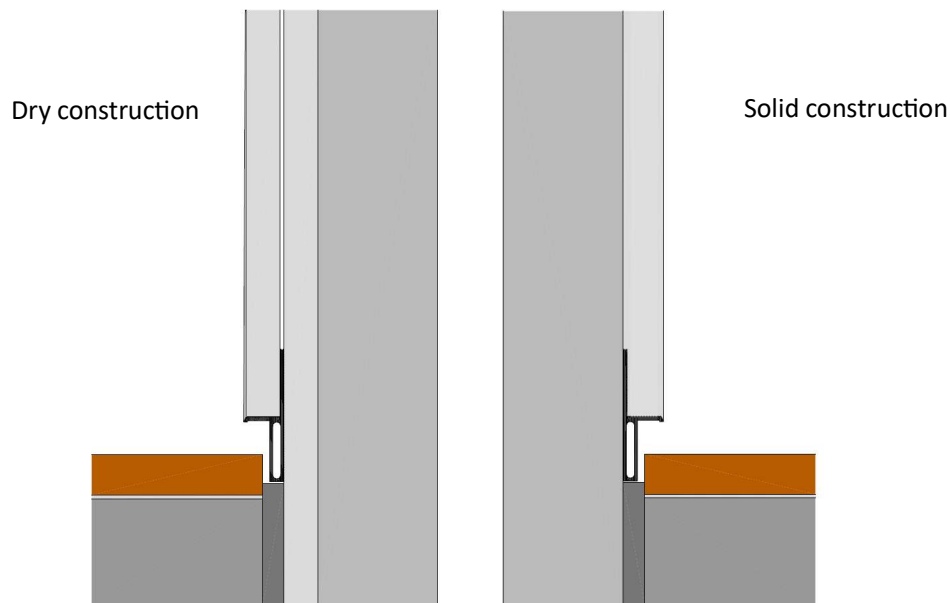
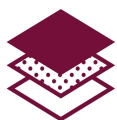

The shadow gaps profiles consist of a raw aluminium alloy EN EW-6060 (Al-MgSi) with a possible toleration according to UNI EN 755-9. This alloy offers good strength value, is corrosion-resistant and is particularly suitable as a construction material for high surface requirements.

Cement and its derivatives produce, in wet conditions, alkaline substances which could possibly lead to corrosion.

Corrosion is prevented by the recommended on-site priming and painting of the profile in wall paint. Aluminium is not resistant to all chemical compounds, therefore contact with hydrogen chloride (HCl) and phosphoric acid (H₃PO₄) should be avoided.

Products for cleaning stones, ceramics etc. can also damage the surface.

However, as the flush-mounted profile is not directly visible, this has no influence on the quality in the installed condition.

Moisture or salt water can discolour the surface of the profile.

Installation



The profiles enable accurate and quick installation, ensuring perfect lines.

The installation can be carried out with or without subfloor and is carried out before the plastering work.

With regard to installation in apartments or houses with proof of energy efficiency, it is recommended to obtain detailed information.

Please read the assembly instructions carefully before starting the assembly work. Only use the materials recommended by AGS-systems for professional installation. Otherwise any liability expires.

Assembly and installing video:



solid construction



dry construction

Shadow gaps



No baseboards are attached to the S22 flush-mounted profiles, as these are shadow gap profiles.

Profiles

The aluminium profiles are provided with a protective foil and are pre-drilled and supplied with a length of 2000 mm.

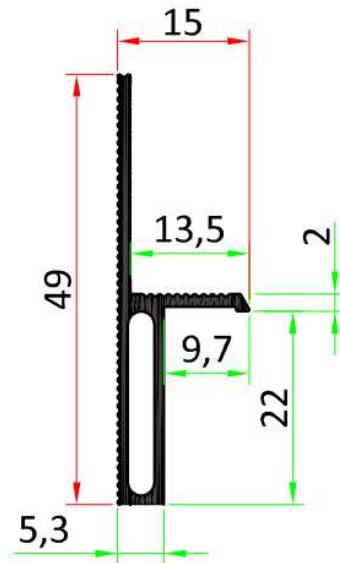

S22 profile		
<u>Solid construction</u>		
Description	Item number	Height
S22	10022	20 mm
<u>Dry construction</u>		
Description	Item number	Height
S22	10022	20 mm

We guarantee for a high quality of our products. Our processing guidelines are based on tests and practical experiences; they are only indication without assurance of properties, we have no influence on condition of construction sites and the realizations of the works.

Country specific regulations, which consist on regional standards, building regulations, processing and industrial guidelines, can guide to specific processing recommendations.